

Top View

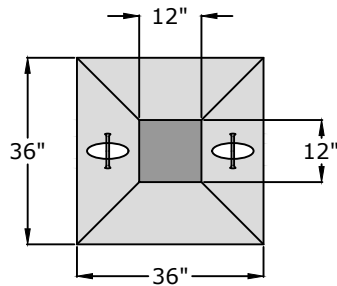

1. Two embedded lift anchors
3,500 lb each (tension)
5,400 lb each (shear)

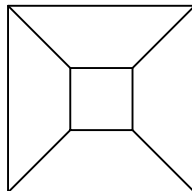

Side View

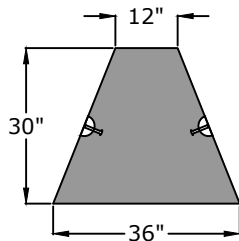

Approved for Production

Project: _____

Date: _____

Quantity: _____

By: _____

Drawn by: Eric Barger

Date: 8.082024

Specifications

Concrete: 5,000 psi minimum strength (28 day)

BARGER
PRECAST

P.O. Box 370 - Kingston TN 37763
Phone 888.882.5860 - BargerPrecast.com

Dragon Tooth