

Top View

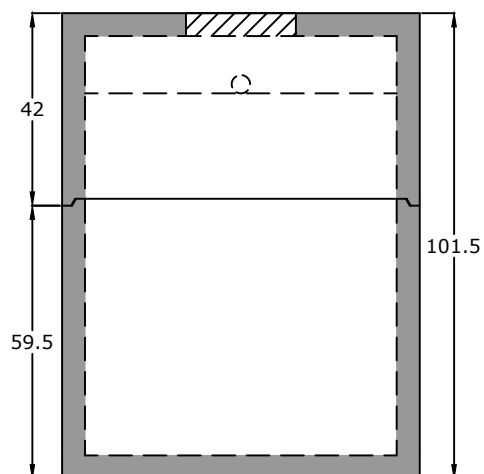

End View

Notes:

ASTM C 1613 Compliant
4" Inlet/Outlet (Standard)
4" PVC 90 in Baffle Wall
2/3 - 1/3 Compartment Capacity

Stencil

[Date of manufacture]
4000 Gallons
150 lb/sq ft
3' of cover
[Inlet/Outlet Size]
"Inlet" and "Outlet"

ASTM C 990 Butyl Sealant

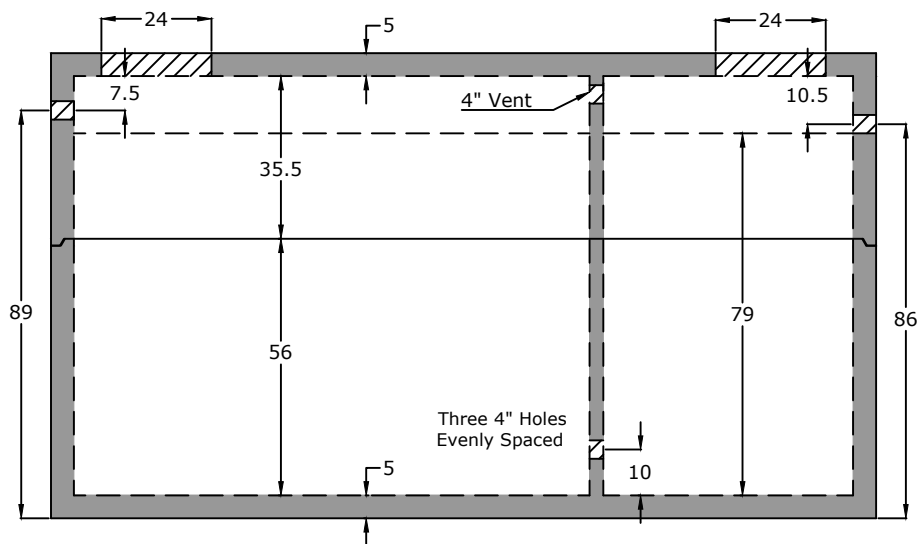
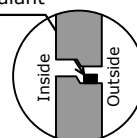

Side View

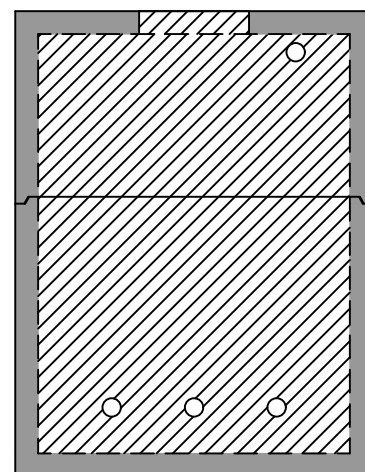

Baffle View

Specifications

Concrete: 5,000 psi minimum strength (28 day)
Reinforcing: Primary reinforcement will be rebar.
Risers: Grade rings and manhole frames and covers sold separately.
Sealant: Sealant used in the seam of the tank will meet or exceed ASTM C990.
Pipe Penetrations: Inlet and outlets are fitted with seals that meet or exceed all ASTM C923 specifications.
Partition Wall: The partition wall, if present, is poured monolithically.
Drawing: All measurements are accurate within ± 1 inch.

Tank Warranty: See Terms and Conditions.

Centroid(s): Lid (91, 39), Base (92, 39)

BARGER
PRECAST

Weights

Top - 13,786 lb
Bottom - 18,886 lb

Anti-Float Protection
46" of water

Installation: The tank hole is not to be more than 18 in. longer and wider than the tank. There shall be a minimum of 6" of 3/4" stone bedding. Do not install across path of vehicles or heavy equipment. This tank is designed for one hundred fifty pounds per square foot (150 lb/ft²) uniform loading on the top of the tank with a max backfill cover of 36" and a minimum of 6".

4,000 Gallon Grease Trap
Hamilton County WWTa - Hamilton County, TN

P.O. Box 370 - Kingston TN 37763
Phone 888.882.5860 - BargerPrecast.com

Date: 12.212012

Drawn By: Eric Barger

Updated: 7.222024