

Top View

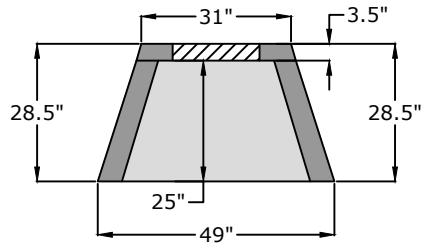

| Hole Dia. (in.) | Weight (lb.) |
|-----------------|--------------|
| 8"              | 885          |
| 10"             | 877          |
| 12"             | 866          |
| 16"             | 840          |

Front View

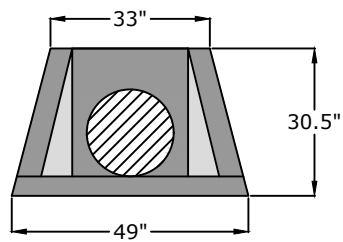

Side View

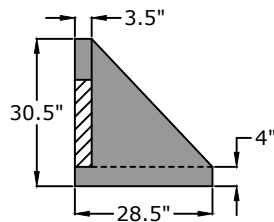

**Approved for Production**

**Project:** \_\_\_\_\_

**Date:** \_\_\_\_\_

**Quantity:** \_\_\_\_\_

**By:** \_\_\_\_\_

**Drawn by:** Eric Barger

**Date:** 8.122024

**Specifications**

**Concrete:** 5,000 psi minimum strength (28 day)

**BARGER  
PRECAST**

P.O. Box 370 - Kingston TN 37763  
Phone 888.882.5860 - BargerPrecast.com

**Headwall Extra Small**