

Top View

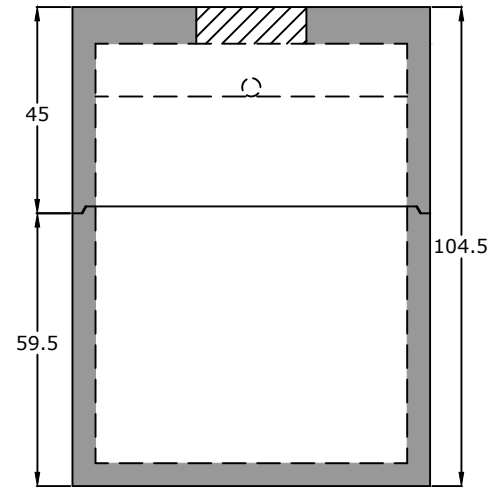

End View

**Notes:**  
 ASTM C 1613 Compliant  
 HS20 Traffic Rated  
 4" Inlet/Outlet (Standard)  
 6" Hole in Baffle Wall  
 2/3 - 1/3 Compartment Capacity

ASTM C 990 Butyl Sealant

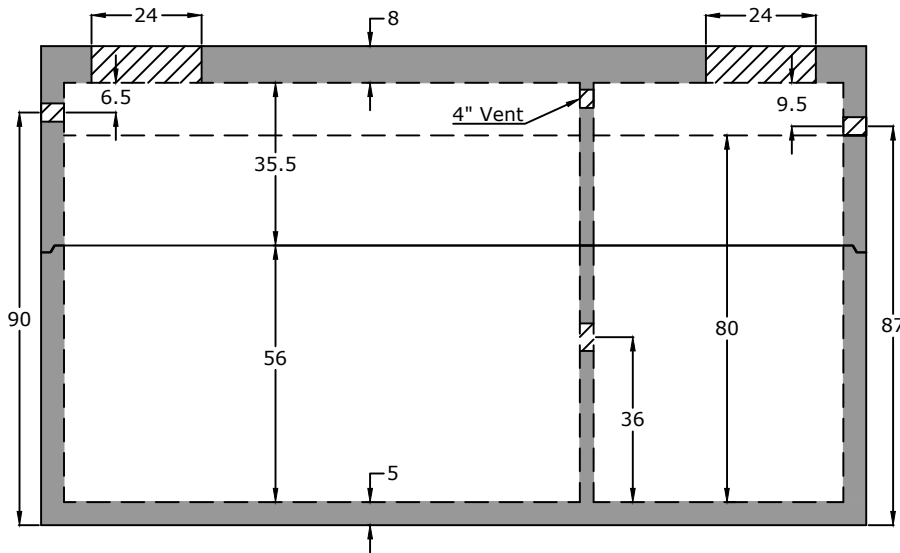
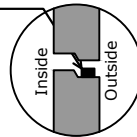

Side View

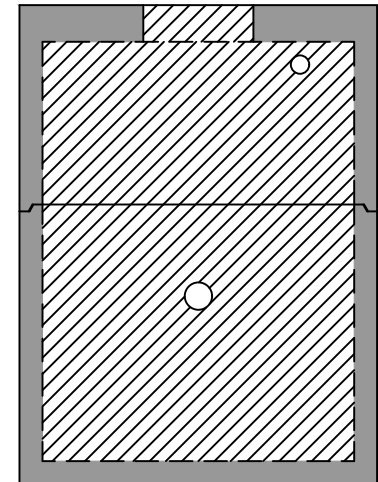

Baffle View

## Specifications

**Concrete:** 5,000 psi minimum strength (28 day)

**Reinforcing:** Primary reinforcement will be rebar.

**Risers:** Grade rings and manhole frames and covers sold separately.

**Sealant:** Sealant used in the seam of the tank will meet or exceed ASTM C990.

**Pipe Penetrations:** Inlet and outlets are fitted with seals that meet or exceed all ASTM C923 specifications.

**Partition Wall:** The partition wall, if present, is poured monolithically.

**Drawing:** All measurements are accurate within  $\pm 1$  inch.

**Tank Warranty:** See Terms and Conditions.

**Centroid(s):** Lid (91, 39), Base (92, 39)

# BARGER PRECAST

P.O. Box 370 - Kingston TN 37763  
 Phone 888.882.5860 - BargerPrecast.com

## Weights

Top - 17,161 lb  
 Bottom - 18,886 lb

## Anti-Float Protection

42" of water

**Installation:** The tank hole is not to be more than 18 in. longer and wider than the tank. There shall be a minimum of 6" of 3/4" stone bedding. This tank is designed for HS20 traffic loads and with a max backfill cover of 3' and a minimum of 6".

**4,000 Gallon HS20 Grease Trap**  
**Kingsport, TN**

Date: 5.102010

Drawn By: Eric Barger

Updated: 7.252024