

Top View

**Notes:**  
4" Inlet (Standard)

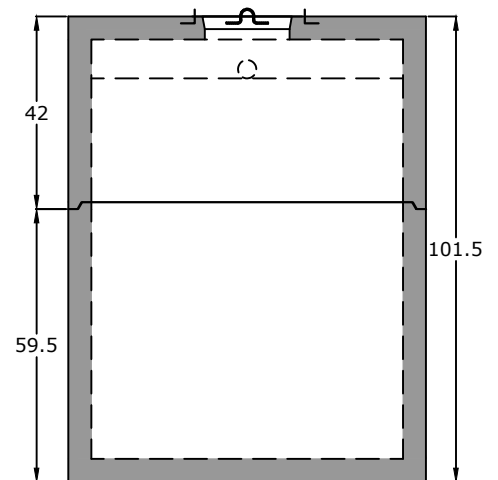

End View

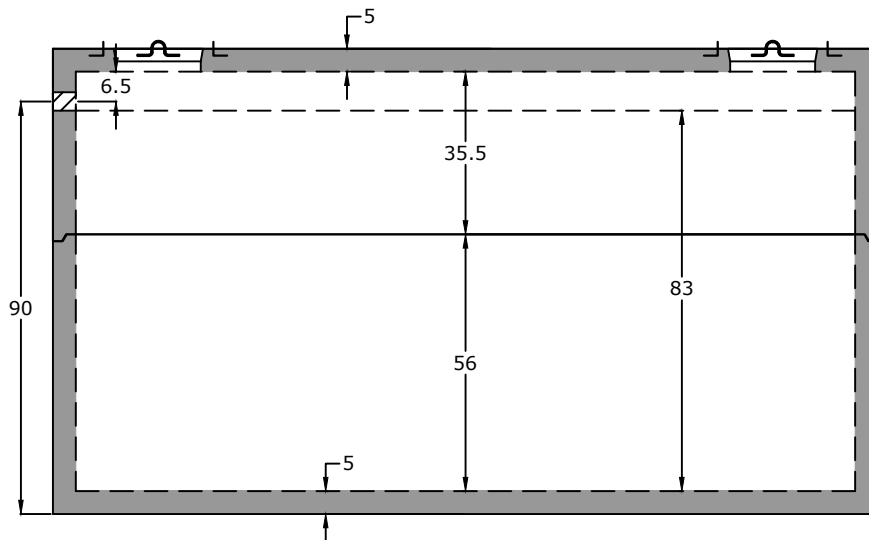

Side View

ASTM C 990 Butyl Sealant

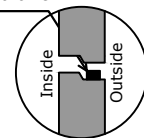

## Specifications

**Concrete:** 5,000 psi minimum strength (28 day)

**Reinforcing:** Primary reinforcement will be rebar.

**Risers:** Grade rings and manhole frames and covers sold separately.

**Sealant:** Sealant used in the seam of the tank will meet or exceed ASTM C990.

**Pipe Penetrations:** Inlet and outlets are fitted with seals that meet or exceed all ASTM C923 specifications.

**Partition Wall:** The partition wall, if present, is poured monolithically.

**Drawing:** All measurements are accurate within  $\pm 1$  inch.

**Tank Warranty:** See Terms & Conditions.

**Centroid(s):** Lid (90, 39), Base (90, 39)

# BARGER PRECAST

P.O. Box 370 - Kingston TN 37763  
Phone 888.882.5860 - BargerPrecast.com

## Weights

Top - 13,323 lb

Bottom - 17,907 lb

## Anti-Float Protection

49" of water

**Installation:** The tank hole is not to be more than 18 in. longer and wider than the tank. There shall be a minimum of 6" of 3/4" stone bedding. Do not install across path of vehicles or heavy equipment. This tank is designed for one hundred fifty pounds per square foot (150 lb/ft<sup>2</sup>) uniform loading on the top of the tank with a max backfill cover of 36" and a minimum of 6".

## 4,000 Gallon Pump Tank

Date: 3.072019

Drawn By: Eric Barger

Updated: 7.182024