

Top View

**Notes:**

HS20 Traffic Rated  
4" Inlet (Standard)

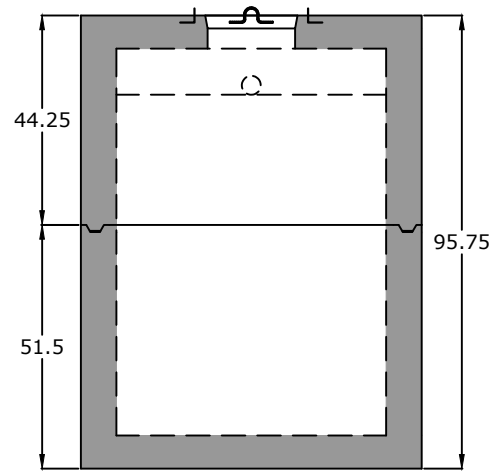

End View

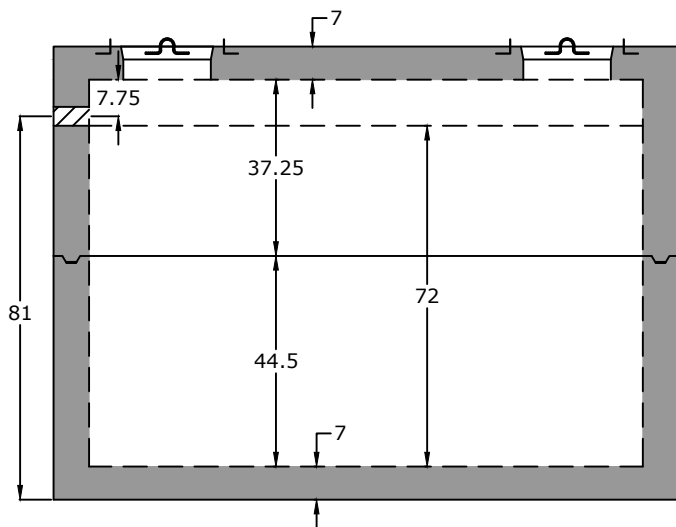

Side View

ASTM C 990 Butyl Sealant

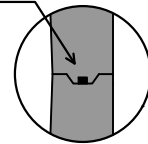

**Specifications**

**Concrete:** 5,000 psi minimum strength (28 day)  
**Reinforcing:** Primary reinforcement will be rebar.  
**Risers:** Grade rings and manhole frames and covers sold separately.  
**Sealant:** Sealant used in the seam of the tank will meet or exceed ASTM C990.  
**Pipe Penetrations:** Inlet and outlets are fitted with seals that meet or exceed all ASTM C923 specifications.  
**Partition Wall:** The partition wall, if present, is poured monolithically.  
**Drawing:** All measurements are accurate within  $\pm 1$  inch.

**Tank Warranty:** See Terms & Conditions.

**Centroid(s):** Lid (66, 36), Base (66, 36)

**BARGER**  
**PRECAST**

P.O. Box 370 - Kingston TN 37763  
Phone 888.882.5860 - BargerPrecast.com

**Weights**

Top - 14,420 lb  
Bottom - 16,503 lb

**Anti-Float Protection**  
9" of water

**Installation:** The tank hole is not to be more than 18 in. longer and wider than the tank. There shall be a minimum of 6" of 3/4" stone bedding. This tank is designed for HS20 traffic loads and with a max backfill cover of 8' and a minimum of 6".

**2,000 Gallon HS20 Pump Tank**

Date: 5.102010

Drawn By: Eric Barger

Updated: 7.222024