

Side View

Top View

Flat Top

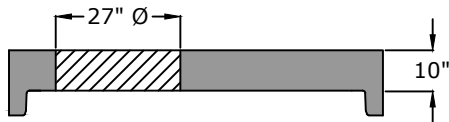

Flat Top
10" - 3,700 lb.

Sized for Project Requirements

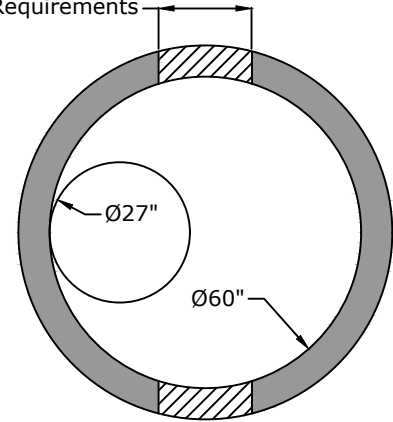

Riser

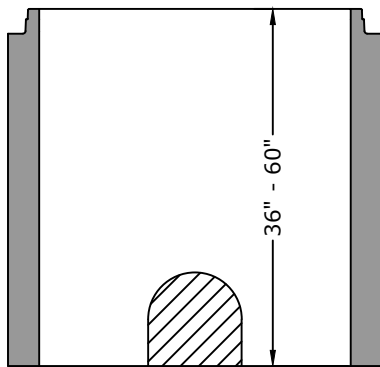

Riser Weights
36" - 3,600 lb.
48" - 5,100 lb.
60" - 6,500 lb.

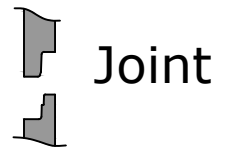

Approved for Production

Project: _____

Date: _____

Quantity: _____

By: _____

Drawn by: Samantha Lowe

Date: 9.172025

BARGER PRECAST

P.O. Box 370 - Kingston TN 37763
Phone 888.882.5860 - BargerPrecast.com

Specifications

Concrete: 4,500 psi minimum 28 day compressive strength

Reinforcing: Per ASTM C478 with design calculations performed by a Licensed P.E. Minimum 2" cover of all reinforcing steel.

Pipe Penetrations: All pipe penetrations are placed according to job requirements.

Pipe Seals: All pipe boots will meet ASTM C990.

Sealant: Sealant used will meet ASTM C923.

Steps: On 16" centers unless otherwise specified.

Preformed Invert: As required by plans or governing specifications.

**60" ID Air Release
(Flat Top)**